



DISC BRAKES

PREMIUM PERFORMANCE BRAKES

INSTALLATION INSTRUCTIONS

Vented Disc Brake

IMPORTANT: READ AND UNDERSTAND THE ENTIRE INSTRUCTION/ASSEMBLY PROCEDURE BEFORE INSTALLATION.

Vented rotor disc brakes are designed to activate when the vehicle's brakes are applied. As the vehicle stops or slows, the momentum of the trailer pushes forward, developing pressure in the actuator (master cylinder), which is used to apply pressure to the brakes.

Check your trailer frequently for any leaks in the hydraulic system, which includes the actuator, brake lines and brakes.

The brake rotors are made of iron and will show surface rust on the braking surface when not used for a week or more. Normal use will wipe the rust off of the rotor surface. If the trailer is used in salt water, it is recommended that you rinse off the brakes with fresh water after each use to reduce the effects of saltwater corrosion.

Your trailer should tow easily. Disc brakes operate at a higher temperature than drum brakes. This is normal and is very similar to the way disc brakes operate on your vehicle. If for any reason your trailer does not tow easily or wants to veer to one side, stop and investigate immediately and solve the problem.

Towing a trailer (even a trailer with brakes) puts an added load on the tow vehicle's handling and braking capabilities. Do not follow too closely; you will need extra distance to maneuver and to stop.

Towing downhill puts added stress on both the tow vehicle and the trailer. Slow down before you start on an incline and maintain a controlled downhill speed with repeated application of brakes followed by a cooling period when brakes are not applied. It is very important to start off with a slow speed and maintain it rather than trying to slow down from a higher speed. Should you feel the brakes on the trailer or tow vehicle are running hot or showing signs of fade, stop immediately on the side of the road and allow the brakes to cool before resuming your trip.

Should you feel the tow vehicle and trailer brakes are not working as they should, have the tow vehicle and trailer inspected. Make sure your trailer's Gross Vehicle Weight (GVW) is within the tow vehicles capacity. If your trailer has multiple axles, verify that the GVW of the trailer does not exceed the capacity of the brakes, which is 3750 lbs on 10" (5 lug) brakes and 6000 lbs on 12" (6 lug) brakes, per axle. Some states require brakes on all axles. Check with your state laws and the state laws of where you will be using your trailer.

After long trips or downhill towing, let brakes cool down before submerging in cold water. The change in temperature of hot brakes submerged in water creates additional stress on the parts and could cause damage to them.

Replace pads when the friction material is 3/32" or less. Original Dexter brake pads have a GalvX coated backing plate that aids in corrosion resistance.

Use DOT 3 brake fluid only. DO NOT USE SILICONE BASED BRAKE FLUID.

When backing a trailer with disc brakes, you must have a lockout lever or preferably an electrically operated solenoid to stop brake pressure to the disc brakes. The solenoid is mounted at the rear of the actuator, between the master cylinder and brake line. It has a wire connected to your back up lights to stop or redirect the fluid to keep the brakes from operating.

Replace Brake Pads

1. Elevate the trailer using the manufacturer's instructions. Always use jack stands for support. Do not depend on a jack to support the trailer. Block wheels to keep trailer from rolling.
2. Remove the tire/wheel assembly. Inspect the rotor surface. Check for excessive wear or grooves that may affect braking. Original hat style rotor thickness is .939" with a minimum thickness of .85" or 21.6 mm. Original integral rotor thickness is .75" with a minimum thickness of .67" or 17 mm.
3. Inspect brake pads. Minimum thickness is 3/32". Pads should be replaced if below this width.
4. Remove the caliper by unscrewing the slider pins from the mounting bracket. Be careful to hold the caliper in place so that it does not fall and pull on the brake hose. The inside pad is spring loaded in the caliper piston. Pry this pad out gently with a flat blade screwdriver. The outside pad is held in place with two metal tabs. Use a large pair of pliers to straighten the tabs to remove the outside pad.
5. Clean the rotor with a brake cleaning spray. Replace brake pads in reverse order. The tabs should only be bent enough to hold the pad in place. Do not bend tab too far or the pad will not seat correctly. Outside pad should be able to wiggle after tab is bent.
6. Clean threads on slider bolts and mounting plate. Apply a coating of LIQUID LOCTITE® 263 or equivalent to the internal threads of the mounting bracket only. Insert slider pins through backside of caliper into mounting bracket. Use a 7/16" hex socket and tighten both pins to 40 ft. lbs.

DO NOT REASSEMBLE WITHOUT APPLYING LIQUID LOCTITE® TO THE BACKING PLATE. SLIDER PINS COULD BACK OUT AND CAUSE PERMANENT DAMAGE TO YOUR BRAKES AND TRAILER.

Removing Hub/Rotor

1. If your axle has an integral style rotor, then the hub and rotor are one piece, and will come off as one.
2. If you have a hat style rotor, the rotor will be removed after the wheel and caliper are removed. The hub will come off separate.
3. Elevate the trailer using the manufacturer's instructions. Always use jack stands for support. Do not depend on a jack to support the trailer. Block wheels to keep trailer from rolling.
4. Remove the tire/wheel assembly.
5. Remove the caliper by unscrewing the slider pins from the

mounting bracket. Be careful to hold the caliper in place so that it does not fall and pull on the brake hose. Support the caliper so that it does not “hang” from the brake line.

6. Remove the grease hat from the hub by prying around the edge of the cap.
7. Bend the locking tang washer to the “free” position. If spindle is equipped with a cotter key, straighten cotter key to remove.
8. Remove the spindle nut in a counter clockwise direction and remove the spindle washer.
9. Remove the hub from the spindle. Be careful not to allow bearings to fall out of the hub.
10. Clean bearing and cup surfaces, repack with lithium marine grade grease.
11. Place hub on spindle in reverse order as listed above. Rotate the hub while tightening the spindle nut to approximately 50 ft. lbs. This translates into full hand pressure with a 12” long set of pliers or 12” long wrench.
12. Loosen the spindle nut to remove the torque, do not rotate hub.
13. Finger tighten the spindle nut until snug, backing out only to line up the locking tang washer. Bend the locking tang tab in place, Replace rotor.
14. Clean threads on slider bolts and mounting plate. Apply a coating of LIQUID LOCTITE® 263 or equivalent to the internal threads of the mounting bracket only. Tighten bolts to 40 ft. lbs.

DO NOT REASSEMBLE WITHOUT APPLYING LIQUID LOCTITE® TO THE BACKING PLATE. SLIDER PINS COULD BACK OUT AND CAUSE PERMANENT DAMAGE TO YOUR BRAKES AND TRAILER.

15. Replace cap. Install tire/wheel assembly and tighten wheel nuts to trailer manufacturer specifications. Test wheel for excessive tightness or excessive play. Readjust if necessary. Road test vehicle in a safe place before traveling on main roads in traffic.

Installation/Replacement Instructions for Vented Disc Brakes

1. On a bare axle attach mounting plate to brake flanges with the bleeder in the upright position. Exact positioning will be determined by the brake flange. Use 7/16” x 1-1/4” zinc hex bolts, lock nuts/washers and torque to 40 ft. lbs. Note: brake mounting plates can have 2 or 4 holes for attaching to the axle.
2. If installation is on a completed trailer, remove tire/wheel. This would be a good time to repack wheel bearings and inspect the bearings and seals if it has not been done recently.
3. Install hub (use existing instruction on installing hubs).

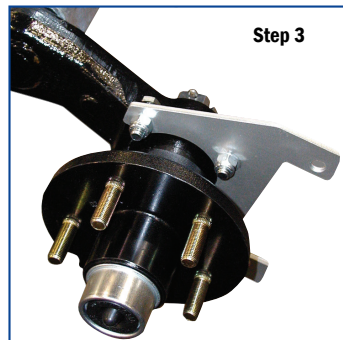
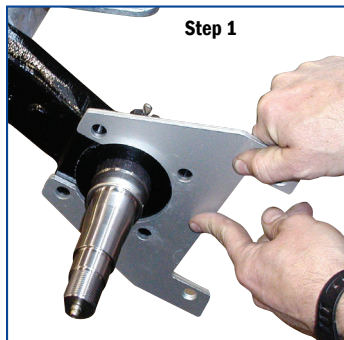

4. Place hat style rotor over hub. Make sure the hub face is clean with a smooth surface or: If installing an integral or “one piece hub

rotor”, install rear bearing and seal. Grease bearings, then install front bearings.

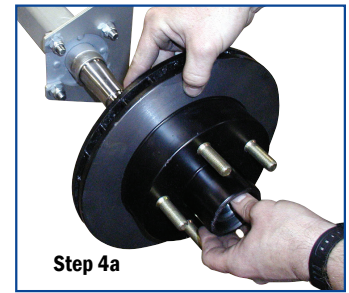
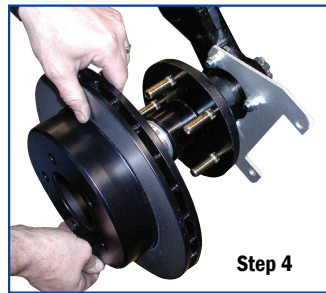

5. Place caliper over rotor and mounting plate. A bleeder valve must be in the up position (see below). Check both calipers for this position. Some calipers have two valves others have only one.
6. Apply a coating of LIQUID LOCTITE® 263 or equivalent to threads on the mounting plate. Insert slider pins through backside of caliper into mounting plate. Use a 7/16” hex socket and tighten both pins to 40 ft. lbs. Check for binding, make sure rotor spins freely. NOTE: If the pins are removed after step 6, the pins/ mounting bracket threads must be cleaned. Apply LOCTITE® 263 to the internal threads of the mounting bracket only. Be careful not to get LOCTITE® on slider pins or bushings.

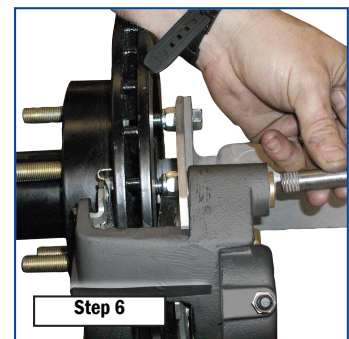
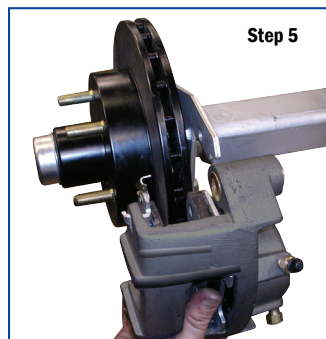

7. Connect brakes lines and bleed brakes before using.

IMPORTANT: WHEN BLEEDING CALIPERS, ALWAYS USE THE TOP MOST BLEEDER VALVE TO ALLOW AIR TO ESCAPE FROM THE CALIPER PISTON

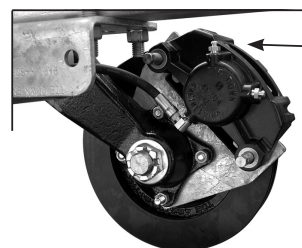

Always bleed through the upper most bleeder valve.